

ADVENTURE RACK BASE

ENG

GENERAL ASSEMBLY INSTRUCTIONS

Important Note: Please follow these instructions carefully.
Holdfast may not be held liable for any damage caused by incorrect installation of this product.

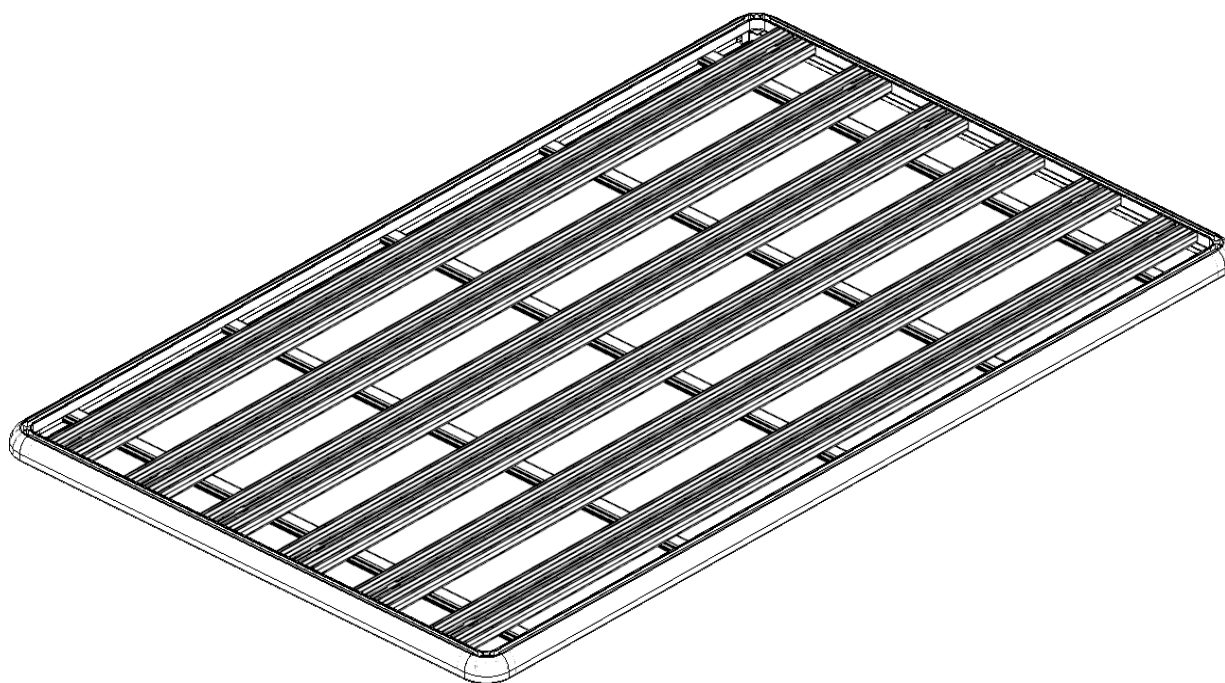

COMPONENTS

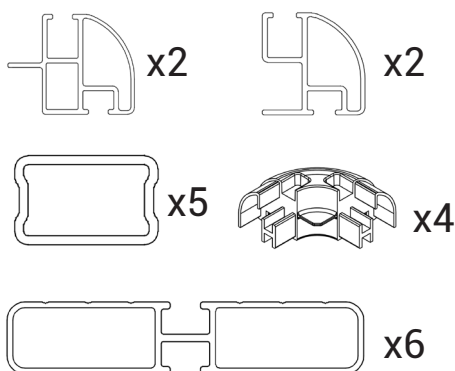

FASTENERS

1	M8x35 BUTTON HEAD BOLT	18
2	M8x15 HEX BOLT	42
3	M8 NUT	18
4	M8 FLANGE NUT	42
5	M8 SPLIT WASHER	18

TOOLS

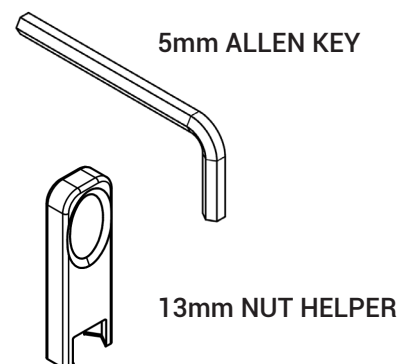

PLEASE NOTE: DEPENDING ON THE SIZE OF THE ADVENTURE RACK ORDERED, THE QUANTITY OF THE COMPONENTS AND FASTENERS MAY DIFFER.

HOLDFAST

BUILD INSTRUCTION:

STEP 1

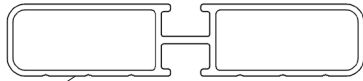

TEXTURED SIDE DOWN.

PLACE ALL MAIN BASE SECTIONS UPSIDE DOWN ON A LARGE OPEN ASSEMBLY SURFACE.

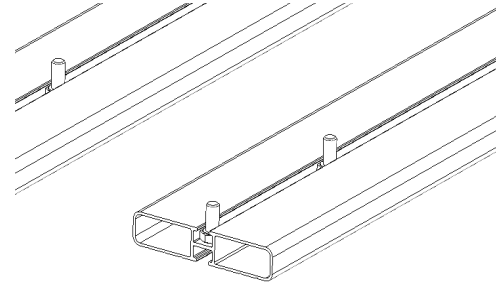
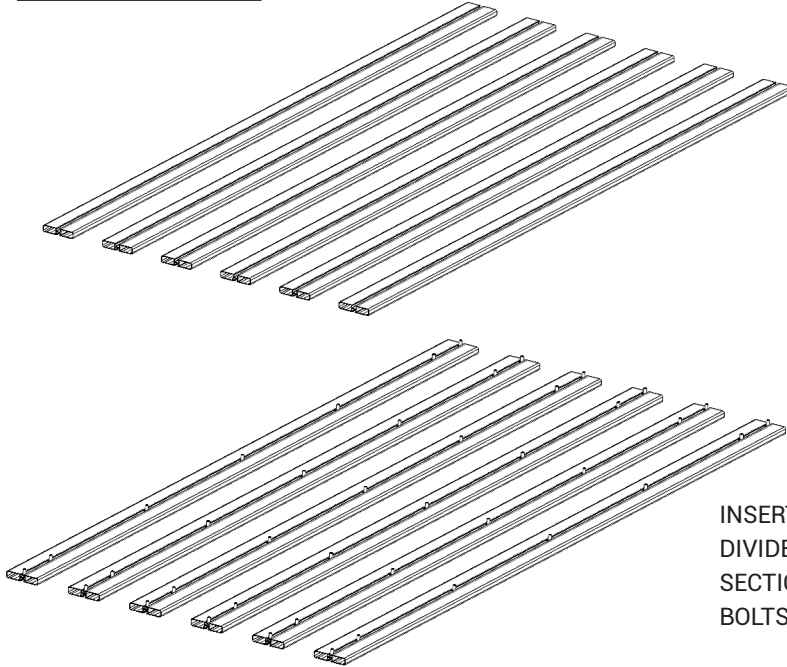

INSERT THE M8x16 HEX BOLT INTO THE LOWER T-SLOT. DIVIDE THE BOLT EQUALLY BETWEEN EACH BASE SECTION. eg 6 BASE SECTION & 42 M8x16 BOLTS = 7 BOLTS INTO EACH SECTION.

STEP 2

PLACE UPSIDE DOWN



PLACE THE FRONT AND BACK SECTIONS ONTO THE BASE SECTION. USE M8 FLANGE NUT TO SECURE BOTH TOGETHER. MAKE SURE THE BASE IS TIGHT UP AGAINST FRONT SECTION. TIGHTEN M8 NUT TO 50Nm

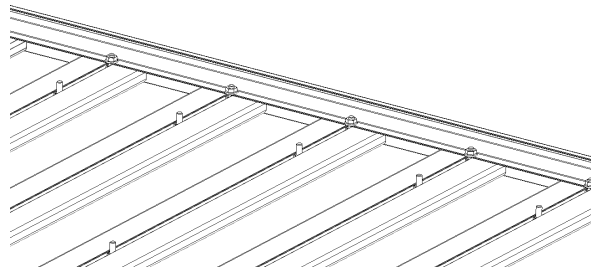
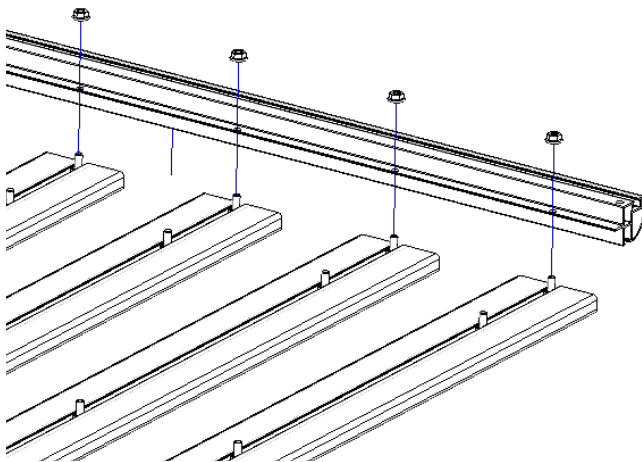

NOTE:
ENSURE BOTH SECTIONS ARE PERPENDICULAR TO ONE ANOTHER.

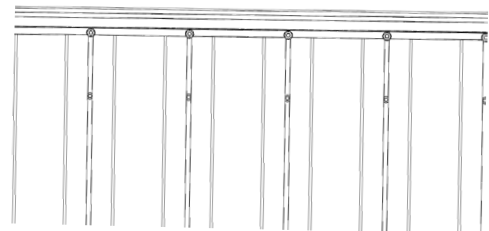

STEP 3

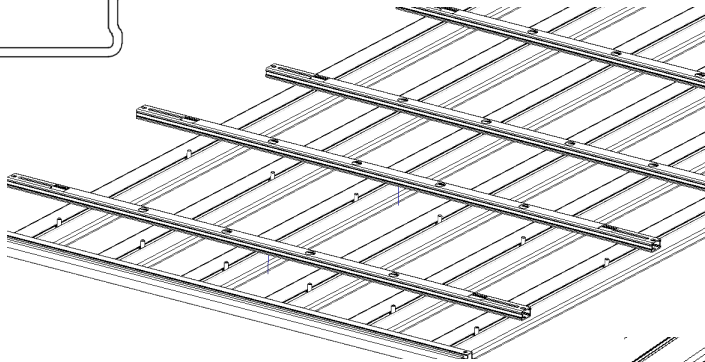
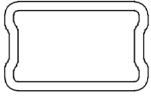

- 1) PLACE CROSS BARS ONTO BOLTS.
- 2) ROUGHLY SPACE CROSS BARS TO MATCH SIDE EXTRUSION HOLES
- 3) PLACE FLANGE NUTS THROUGH THE HOLES USING A 13mm SOCKET OR TUBE SPANNER.

TIP :

DON'T TIGHTEN THE NUTS UNTIL YOU HAVE PUT THE SIDE EXTRUSIONS ON THE RACK. THIS ALLOWS THE CROSS BARS TO SLIDE WHICH MAKE ALIGNING THE HOLES EASIER.

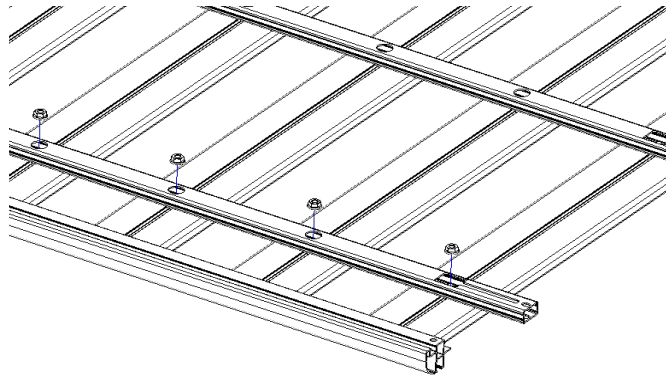

STEP 4

FIRST INSERT CORNER INTO THE SIDE PROFILE INTO BOTH SIDES AND SECURE CORNER WITH M8x35 AND A SPLIT WASHER

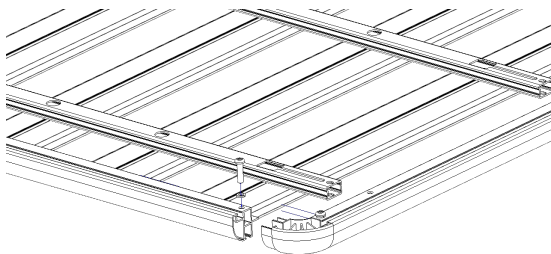
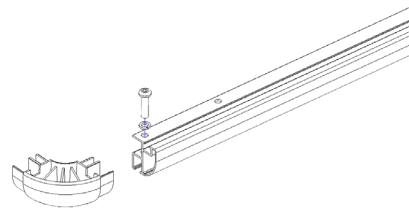

SLIDE THE SIDE EXTRUSIONS WITH CORNERS INTO THE PLATFORM AND SECURE WITH M8x35 AND SLIT WASHER.

SECURE THE REMAINDER OF THE HOLES WITH M8x35 AND SPLIT WASHER.

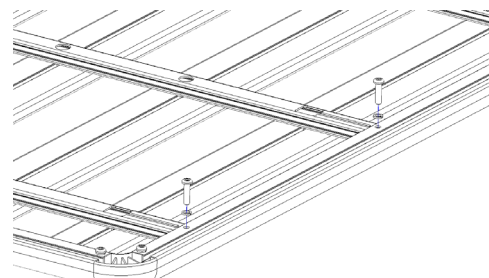

STEP 5

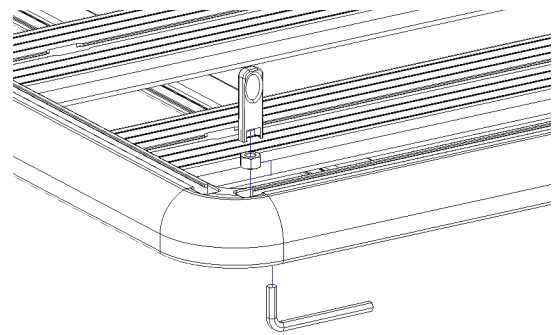
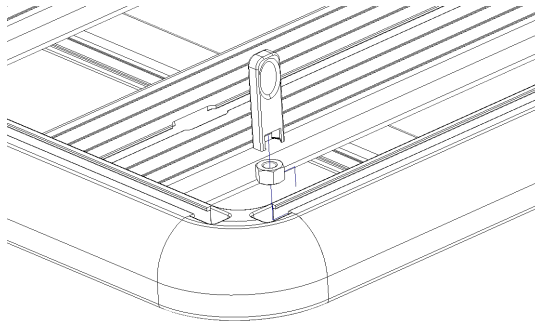
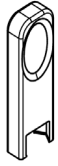

USE THE 13mm NUT HELPER TO GET THE NUTS INTO THE CHANNEL SO YOU CAN USE THE 5mm ALLEN KEY TO TIGHTEN THE BOLTS

NB!!! - REMOVE HELPER TOOL BEFORE TIGHTENING BOLT.

TIGHTEN EACH BOLT TO 20Nm or 15ft lb

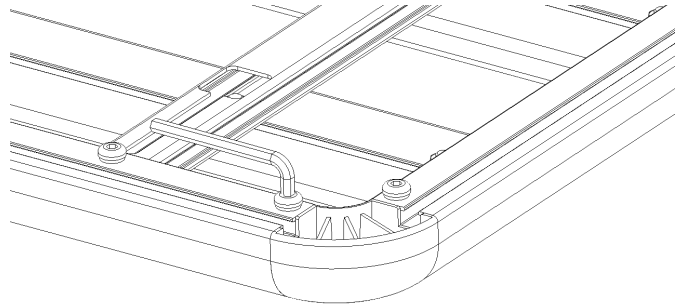

STEP 6

NOW THAT YOUR ADVENTURE RACK IS ASSEMBLED PLEASE PROCEED TO THE CLAMPING KIT INSTRUCTION FOR YOUR SPECIFIC VEHICLE.

TAKING CARE OF YOUR HOLDFAST ADVENTURE RACK.

WHILST ALL HOLDFAST PRODUCTS ARE BUILT TO THE HIGHEST STANDARD AND WITH THE INDUSTRIES' BEST AVAILABLE MATERIALS WE STILL SUGGEST LOOKING AFTER YOUR RACK IN ORDER FOR IT TO LAST A LIFETIME.

ALL OUR FASTENERS ARE 304 STAINLESS STEEL AND SHOULD LAST FOR YEARS HOWEVER IN SALTY CLIMATES WE ADVISE THAT YOU CLEAN YOUR RACK REGULARLY WITH FRESH WATER AND APPLY A SILICON SPRAY AROUND AREAS WHERE THE STAINLESS-STEEL FASTENERS AND THE ALUMINUM EXTRUSION MEET. THE SILICON SPRAY WILL SLOW DOWN THE GALVANIC REACTION BETWEEN THE DIFFERENT MATERIALS.

 BE SURE TO SHARE YOUR EPIC ADVENTURES WITH US: @HOLDFASTSA

HOLDFAST